

**CAMS WITH STOPPERS**

H: Grip  
 LH: Height of housing  
 CL: Cam length  
 CH: Cam height

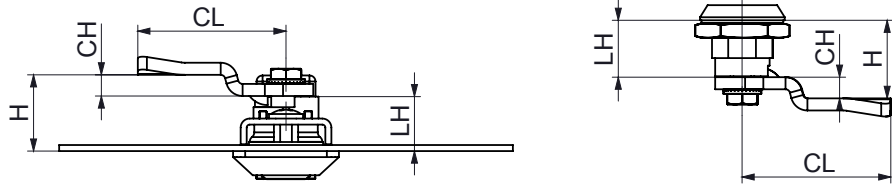

MATERIAL: Steel  
 FINISH: Zinc plated  
 THICKNESS: 4 mm

**Cam 1**

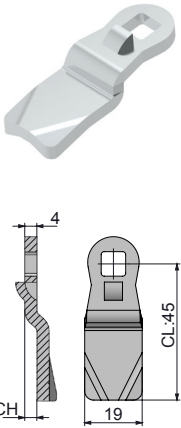

STOCK CODE	CC	CH	CL	LH:18 H	LH:18.5 H	LH:20 H	LH:21 H	LH:30 H	LH:32 H	LH:35 H	LH:40 H	LH:50 H	LH:60 H
30403033Y	30	0	45	18	18.5	20	21	30	32	35	40	50	60
30403439Y	17	1	45	19	19.5	21	22	31	33	36	41	51	61
30403159Y	35	2	45	20	20.5	22	23	32	34	37	42	52	62
30403063Y	31	3	45	21	21.5	23	24	33	35	38	43	53	63
30403149Y	33	4	45	22	22.5	24	25	34	37	39	44	54	64
30403160Y	34	6	45	24	24.5	26	27	36	38	41	46	56	66
30403161Y	36	8	45	26	26.5	28	29	38	40	43	48	58	68
30403162Y	47	10	45	28	28.5	30	31	40	42	45	50	60	70
30403045Y	44	12	45	30	30.5	32	33	42	44	47	52	62	72
30403163Y	48	14	45	32	32.5	34	35	44	46	49	54	64	74
30403151Y	49	16	45	34	34.5	36	37	46	48	51	56	66	76
30403165Y	55	18	45	36	36.5	38	39	48	50	53	58	68	78
30403166Y	56	20	45	38	38.5	40	41	50	52	55	60	70	80
30403167Y	57	22	45	40	40.5	42	43	52	54	57	62	72	82
30403168Y	58	24	45	42	42.5	44	45	54	56	59	64	74	84
30403169Y	37	-2	45	16	16.5	18	19	28	30	33	38	48	58
30403170Y	38	-4	45	14	14.5	16	17	26	28	31	36	46	56
30403171Y	39	-6	45	12	12.5	14	15	24	26	29	34	44	54
30403172Y	59	-8	45	10	10.5	12	13	22	24	27	32	42	52
30403173Y	60	-10	45	8	8.5	10	11	20	22	25	30	40	50
30403174Y	61	-12	45	6	6.5	8	9	18	20	23	28	38	48
30403175Y	62	-14	45	4	4.5	6	7	16	18	21	26	36	46

MATERIAL: Steel  
 FINISH: Zinc plated  
 THICKNESS: 4 mm

**Cam 2**

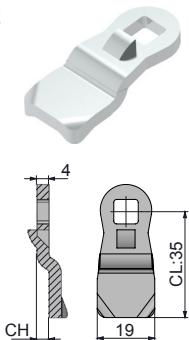

STOCK CODE	CC	CH	CL	LH:18 H	LH:18.5 H	LH:20 H	LH:21 H	LH:30 H	LH:32 H	LH:35 H	LH:40 H	LH:50 H	LH:60 H
30403187Y	11	-2	35	16	16.5	18	19	28	30	33	38	48	58
30403185Y	12	0	35	18	18.5	20	21	30	32	35	40	50	60
30403186Y	13	2	35	20	20.5	22	23	32	34	37	42	52	62
30403188Y	14	4	35	22	22.5	24	25	34	36	39	44	54	64
30403470Y	15	6	35	24	24.5	26	27	36	38	41	46	56	66
30403471Y	16	7	35	25	25.5	27	28	37	39	42	47	57	67
30403189Y	23	10	35	28	28.5	30	31	40	42	45	50	60	70
30403046Y	52	26	35	44	44.5	46	47	56	58	61	66	76	86

## CAMS WITH STOPPERS

MATERIAL: Steel  
FINISH: Zinc plated  
THICKNESS: 4 mm

Cam 3

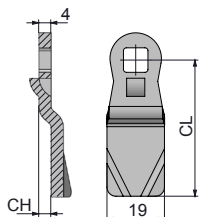

STOCK CODE	CC	CH	CL	LH:18 H	LH:18.5 H	LH:20 H	LH:30 H	LH:32 H	LH:35 H	LH:40 H	LH:50 H	LH:60 H
30403031Y	10	0	29	18	18.5	20	30	32	35	40	50	60
30403032Y	20	0	38	18	18.5	20	30	32	35	40	50	60
30403036Y	70	0	66	18	18.5	20	30	32	35	40	50	60
30403034Y	40	0	51	18	18.5	20	30	32	35	40	50	60
30403037Y	21	3	38	21	21.5	23	33	35	38	43	53	63
30403038Y	41	3	51	21	21.5	23	33	35	38	43	53	63
30403129Y	22	6	37	24	24.5	26	36	38	41	46	56	66
30403039Y	32	7	44	25	25.5	27	37	39	42	47	57	67
30403040Y	42	7	49	25	25.5	27	37	39	42	47	57	67
30403043Y	43	10	48	28	28.5	30	40	42	45	50	60	70

MATERIAL: Steel  
FINISH: Zinc plated  
THICKNESS: 4 mm

Cam 4

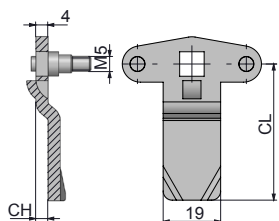

STOCK CODE	CC	CH	CL	LH:18 H	LH:18.5 H	LH:20 H	LH:30 H	LH:32 H	LH:35 H	LH:40 H	LH:50 H	LH:60 H
30403140Y	03	0	51	18	18.5	20	30	32	35	40	50	60
30403522Y	06	0	45	18	18.5	20	30	32	35	40	50	60
30403047Y	01	7	49	25	25.5	27	37	39	42	47	57	67
30403524Y	07	2	45	20	20.5	22	32	34	37	42	52	62
30403526Y	08	3	45	21	21.5	23	33	35	38	43	53	63
30403528Y	09	4	45	22	22.5	24	34	36	39	44	54	64
30403530Y	100	5	45	23	23.5	25	35	37	40	45	55	65
30403532Y	101	6	45	24	24.5	26	36	38	41	46	56	66
30403534Y	102	7	45	25	25.5	27	37	39	42	47	57	67
30403147Y	02	12	46	30	30.5	32	42	44	47	52	62	72
30403536Y	103	14	45	32	32.5	34	44	46	49	54	64	74

MATERIAL: Plastic

Cam 5

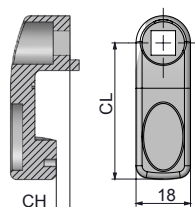

STOCK CODE	CC	CH	CL	LH:18 H	LH:18.5 H	LH:20 H	LH:30 H	LH:35 H	LH:40 H	LH:50 H	LH:60 H
30402004Y	90	0	35	18	18.5	20	30	35	40	50	60
30402011Y	93	0	25	18	18.5	20	30	35	40	50	60
30402005Y	91	6	35	24	24.5	26	36	41	46	56	66
30402008Y	92	4	45	22	22.5	24	34	39	44	54	64
30402013Y	94	-4	45	14	14.5	16	26	31	36	46	56